

Schema di posa

I seguenti punti sono importanti per ordinare le calotte:

1. Pendenza tetto (**inclinazione puntone**) in gradi!
2. Tipo di posa, p.es. davanti sulle tegole (**perdita pendenza**) o sul sottotetto (**nessuna perdita**)

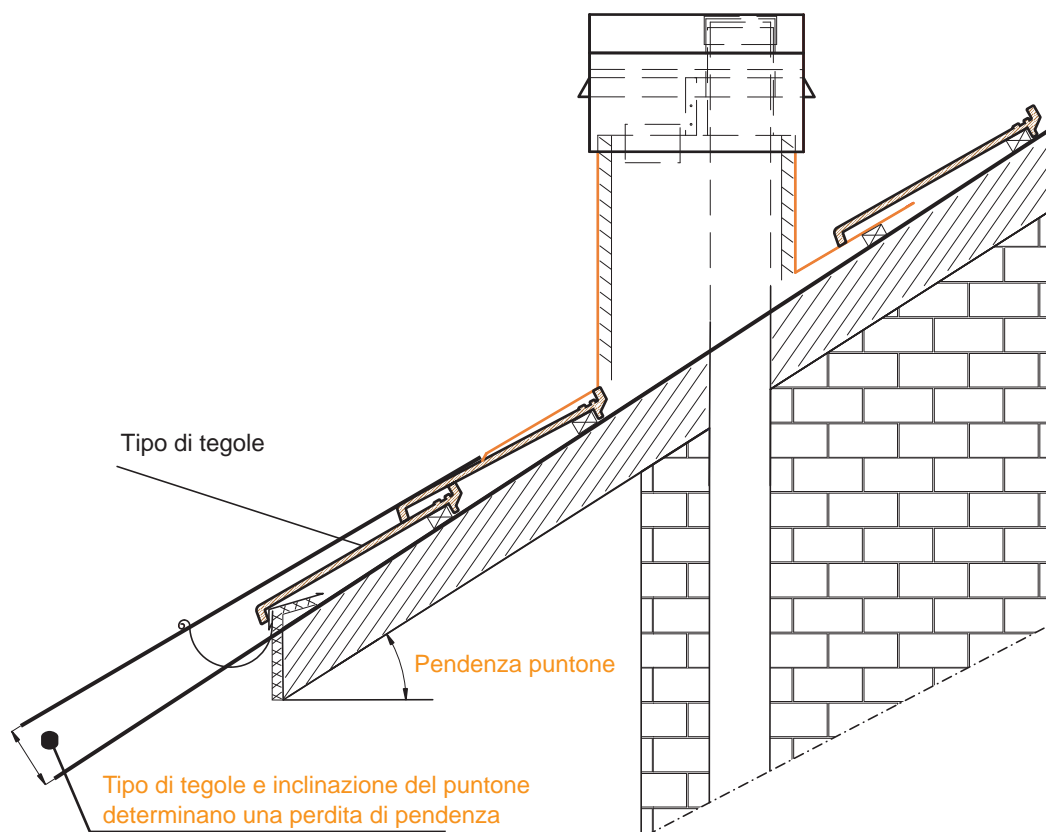

A. Posa in tetto piano sopra l'isolamento

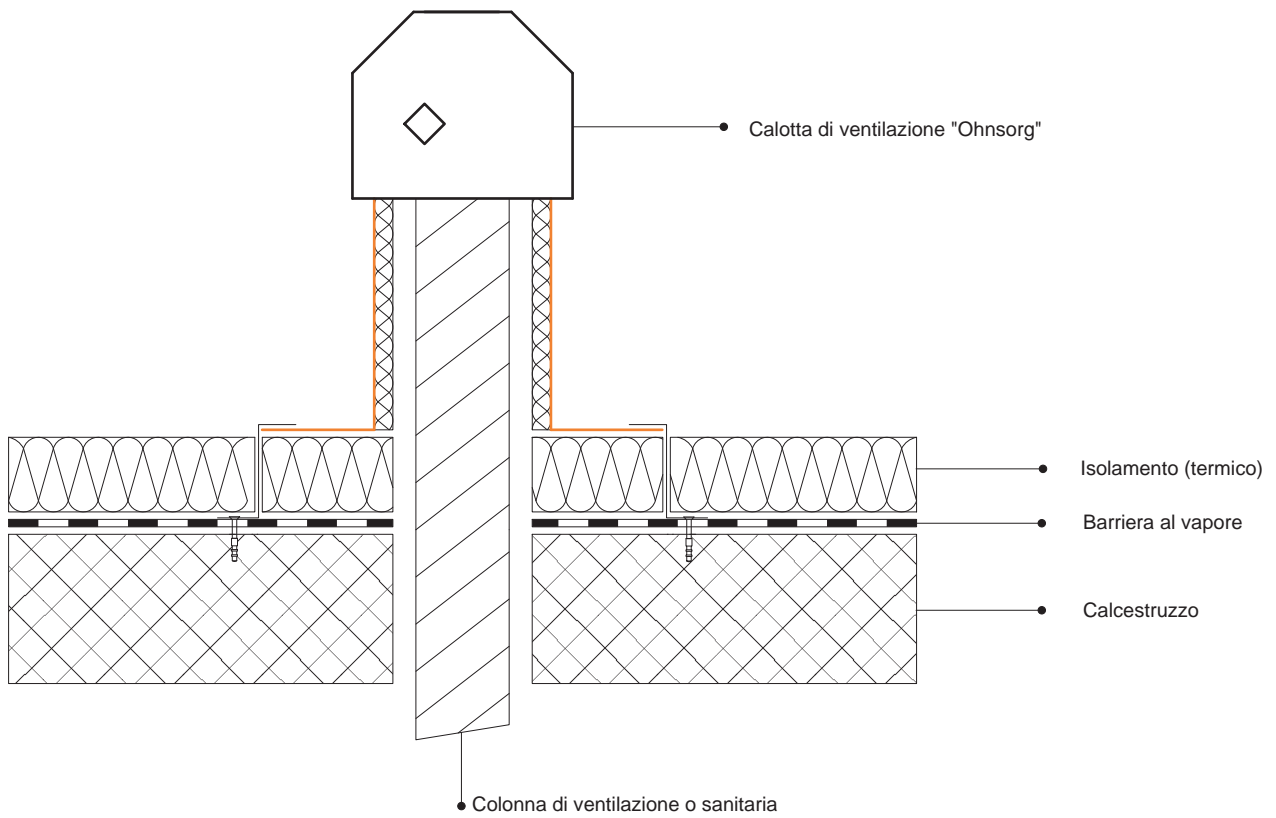

B. Posa in tetto piano **sotto** l'isolamento

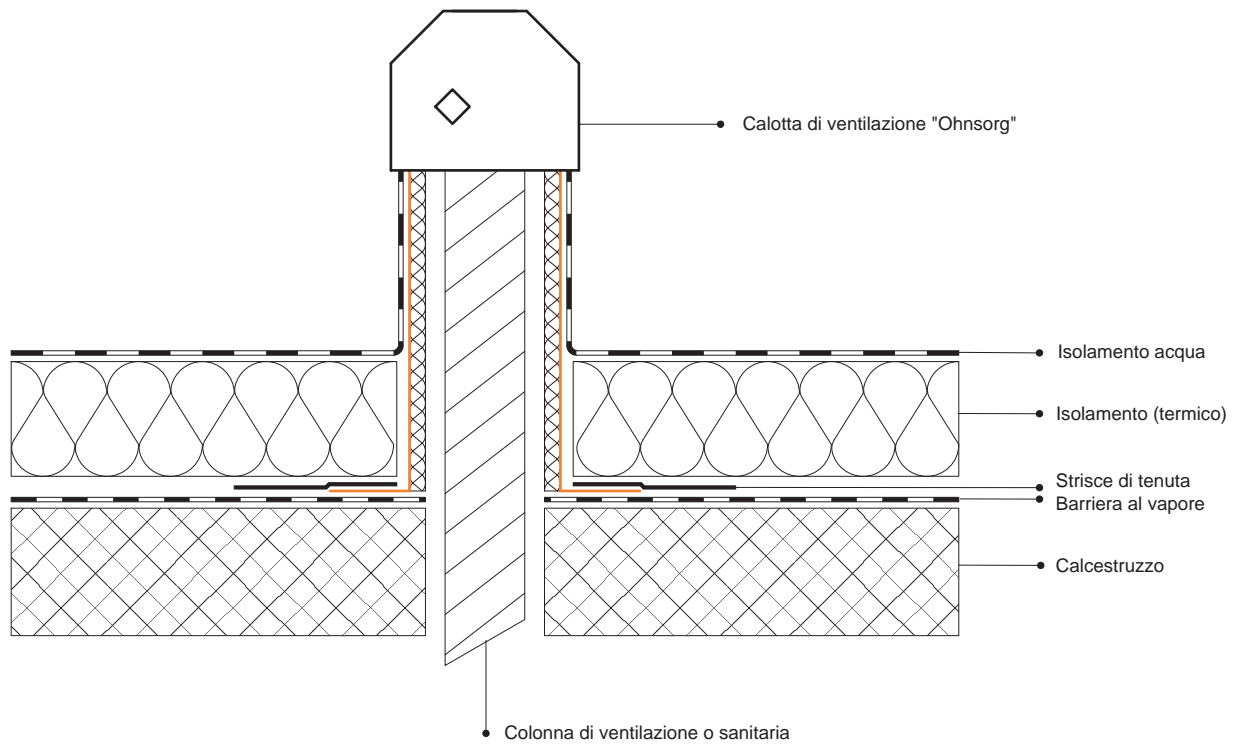

C. Posa **su** tetto in lamiera

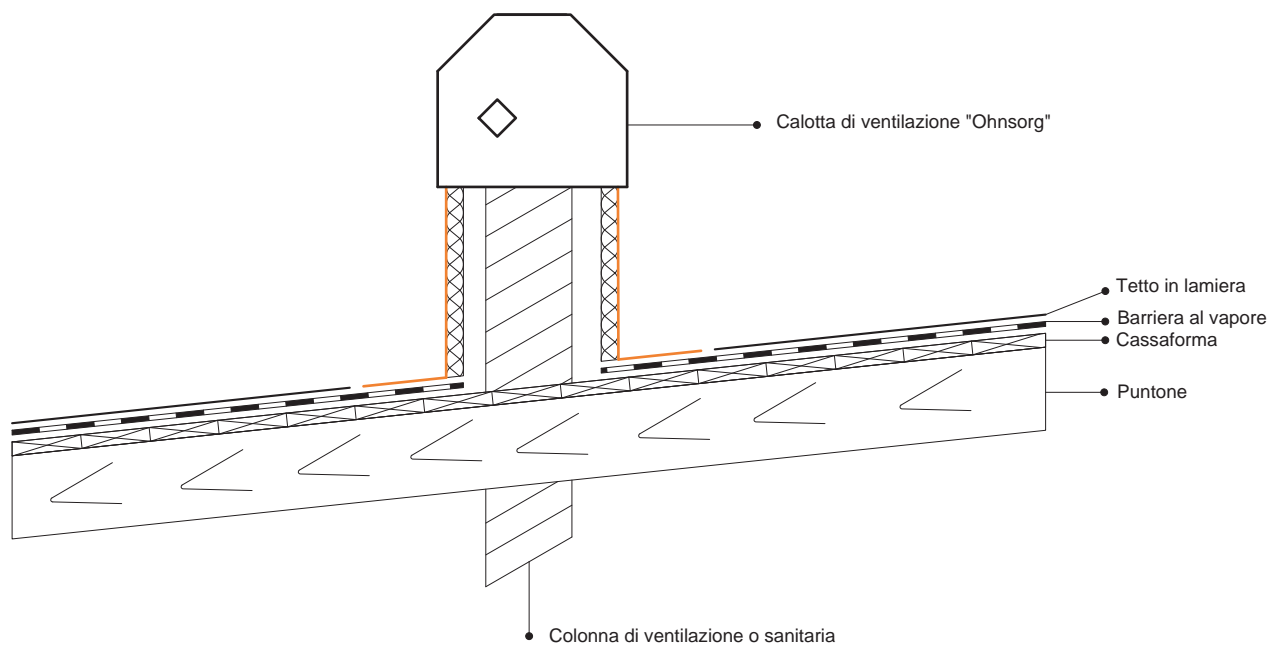

D. Posa **sul** sottotetto

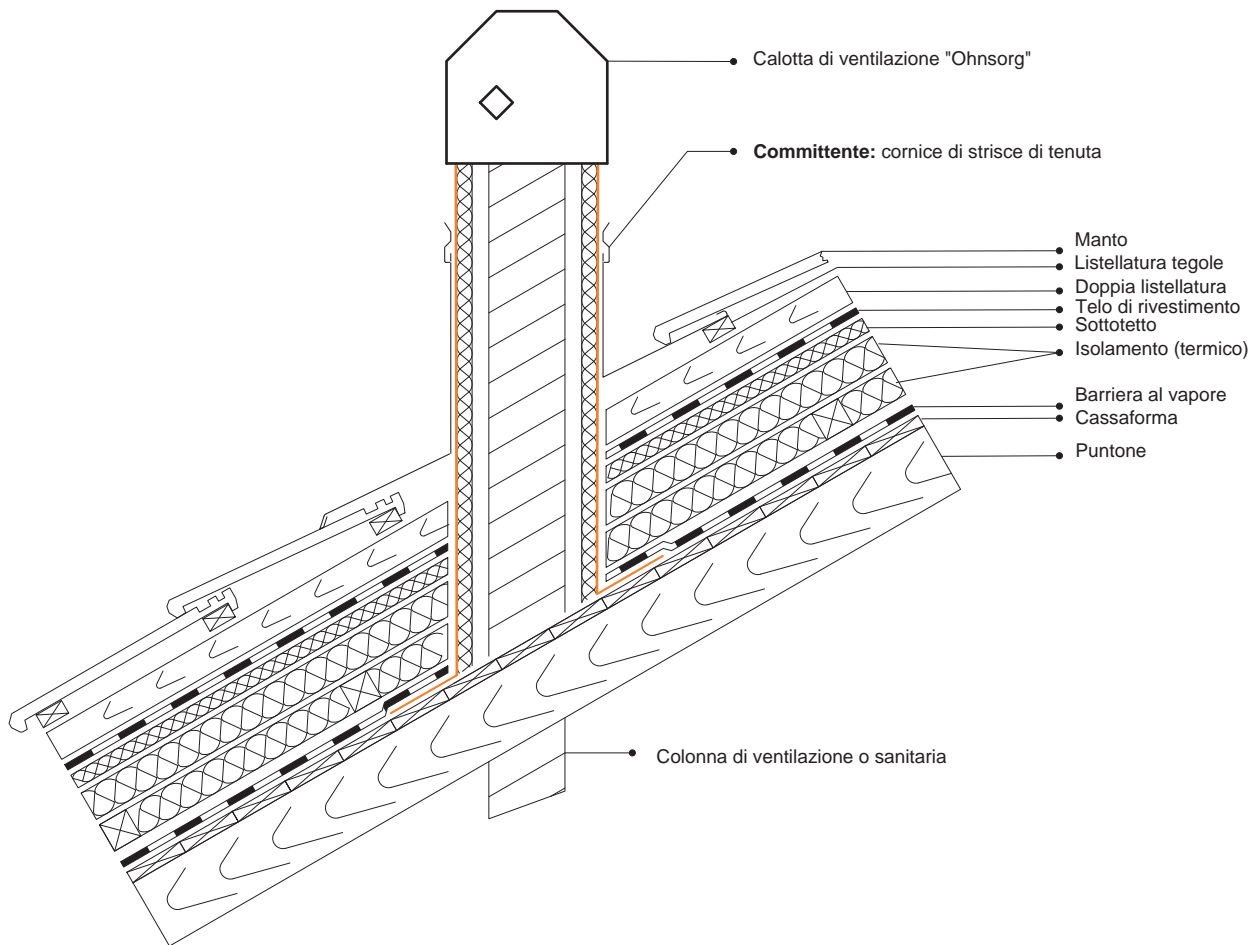

E. Posa **su** tetto di tegole

